

-  Dielectric Grease (92-823506-1)
-  Loctite PST Pipe Sealant (92-809622)

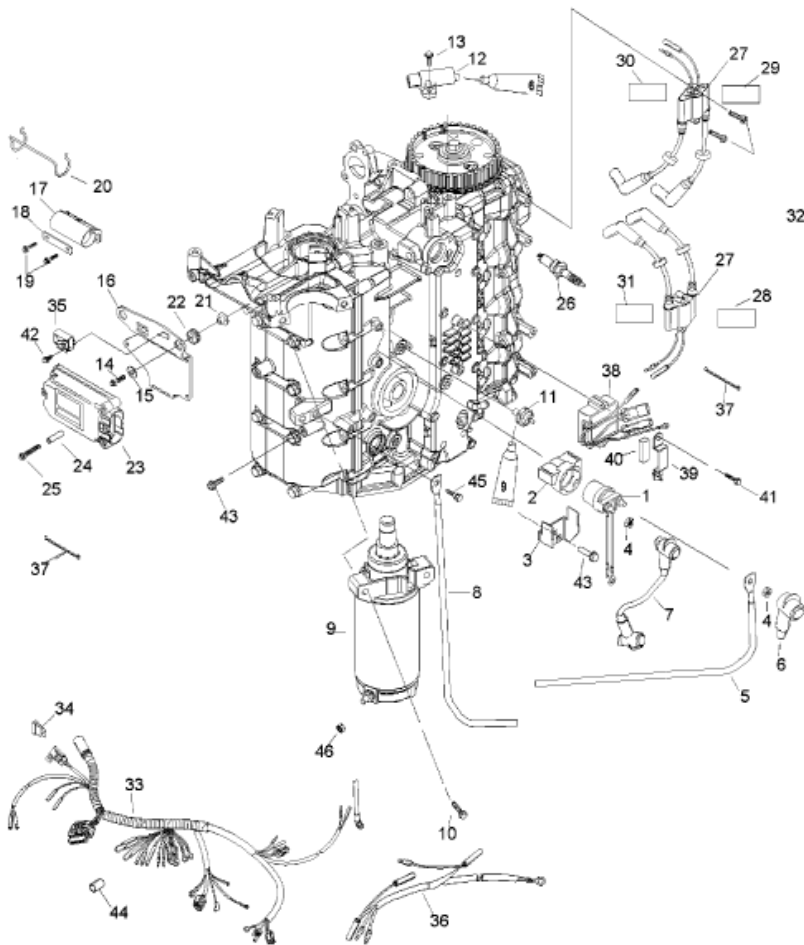

ELECTRICAL COMPONENTS

Parts List					
Ref	Class	Part	Description	Qty	Footnote
1	89	825096T	SOLENOID	1	
2		95643M	BRACKET	1	
3		825074	SOLENOID PLATE	1	
4	11	40138 6	NUT (M6)	2	
5	84	88439A 9	BATTERY CABLE (POSITIVE)	1	
6	85	880786	BOOT (RED)	1	
7	84	93388A16	CABLE	1	
8	84	88439A 4	BATTERY CABLE (NEGATIVE)	1	
9	50	884044T	STARTER MOTOR (SEE BREAKD	1	
10	10	40011153	SCREW (M8 X 45)	3	
11	87	828040 1	PRESSURE SWITCH	1	5
12		828358	SENSOR-CRANK POSITION	1	
13	10	40011107	SCREW (M5 X 16)	2	
14	10	821300 25	SCREW (M6 X 25)	3	
15	12	40023 16	WASHER	3	
16		859224	PLATE	1	
17		856836	RETAINER	1	
18		856040	BRACKET	1	
19	10	821291 14	SCREW (M6 X 14)	2	
20		92753	RETAINER	1	
21	23	856954	BUSHING	3	
22	25	834985	GROMMET	3	
23		878433A 3	ECM	1	
24	23	853920 1	BUSHING	3	
25	10	821291 40	SCREW (M6 X 40)	3	
26	33	827858	SPARK PLUG (NGK DPR6EA-9)	4	
27	339	859738T 1	IGNITION COIL	2	
28		NSS	DECAL	1	(COIL ID #1)
29		NSS	DECAL	1	(COIL ID #2)
30		NSS	DECAL	1	(COIL ID #3)
31		NSS	DECAL	1	(COIL ID #4)
32	10	826844 30	SCREW (M6 X 30)	4	
33	84	857111T 2	ENGINE WIRING HARNESS	1	
34	88	812619	FUSE (SFE 20 AMP)	1	
35		828054	COVER	1	
36	84	852375A 6	HARNESS-EXTENSION	1	(HANDLE)
37	54	816311T	STA-STRAP	AR	
38		883071T 1	VOLTAGE REGULATOR	1	
39		858413	BRACKET	1	
40		830897 1	FOAM PAD	1	
41	10	824822 9	SCREW (M6 X 40)	2	